

Lamp Accessories Plastic

Measurements shown in millimeters (mm). To get inches divide mm by 25.4

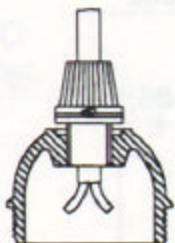

360

Cord Grip (Two parts) with locking washer
For threaded caps M10 x 1 (1/8 IPS)
For round cable H03VV-F (H207, H307)
and SVT 18/2

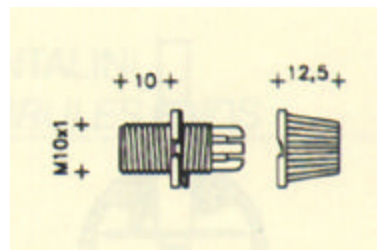

361

Cord Grip (Two parts) with locking washer
M10 x 1 (1/8 IPS) for metal all threads
For round cable H03VV-F (H207, H307)
and SVT 18/2

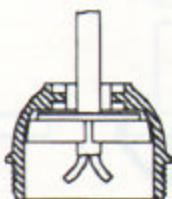
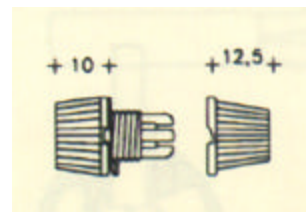

367

Jamming Cord Grip
for Candelabra Base Caps 3000/H19
For flat cable H03VVH2-F (HP07)

362

Jamming Cord Grip
for Medium Base Caps 7000 Series
For flat cable H03VVH2-F (HP07)

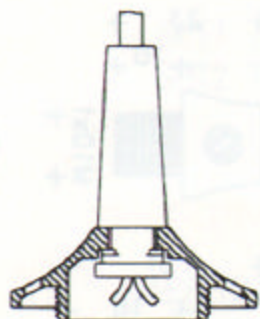
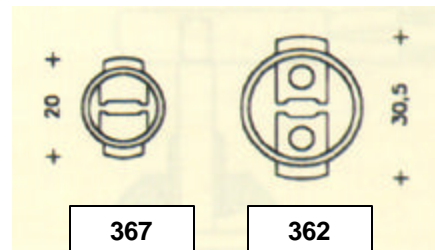

345

Cord Grip with Separator for Caps
For round cable H03VV-F (H207, H307)
and SVT 18/2

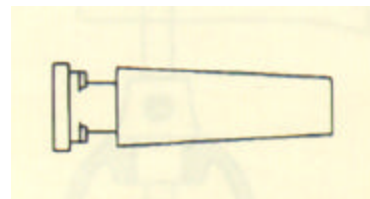

382

Cord Grip for flat cable
H03VVH2-F (HP07)

383

Cord Grip for round cable
H03VV-F (H207, H307)
and SVT 18/2

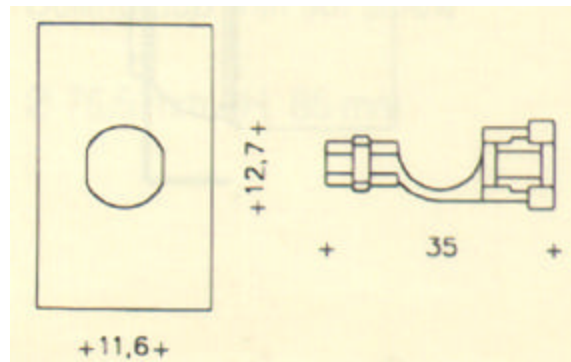

Lamp Accessories

1/8 IPS = Steel Pipe 3/4" OD.
(Slips 7/16" hole)
1/4 IPS = Steel Pipe 1/2" OD.
(Slips 9/16" hole)

Measurements shown in millimeters (mm). To get inches divide mm by 25.4

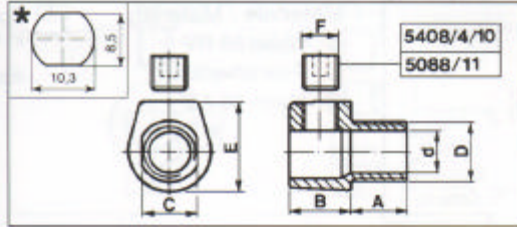

Part Number	Dimensions (mm)						
	A	B	C	D	d	E	F
5100/7/109	9	10	8,5	M10x1	7,2	15	M 7x1
5100/7/114	14	10	8,5	M10x1	7,2	15	M 7x1

5100/7/109

Colors: White, Black, Clear Transparent

5100/7/114

Colors: White, Black

Cord Grip (Cable Clamp) supplied with separate threaded grub.

- 1) Flat Cable H03VVH2-F min Ø 3x4.8 max Ø 3.6x6
- 2) Round Cable H03VV-F min Ø 4.8 and max Ø 6.5

M 10x1: Maximum tightening torque = 130 N cm
Approved for Class II fittings

Application Example for both cord grips 5100/7/109 and 5100/7/114

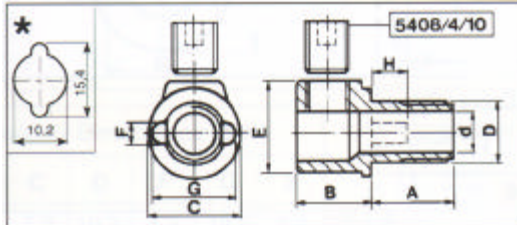
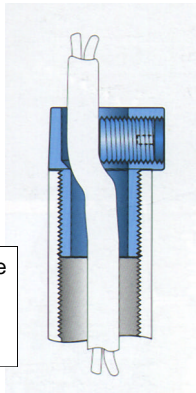

Part Number	Dimensions (mm)								
	A	B	C	D	d	E	F	G	H
5100/6/15	15	10	14,5	M 10x1	6,8	15	3	13,8	6

5100/6/15/C

Cord Grip (Detent Cable Clamp) supplied with separate threaded grub.

Suitable for cables:

- Flat Cable H03VVH2-F min Ø 3x4.8 and max Ø 3.9x6.4
- Round Cable H03VV-F min Ø 4.8 and max Ø 6.5

M 10x1: Maximum tightening torque = 130 N cm

Approved for Class II fittings

Color: Clear Transparent

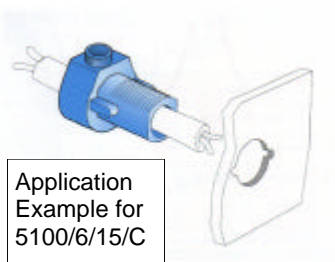

Application Example for 5100/6/15/C

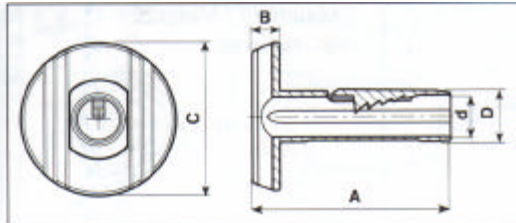

Part Number	Dimensions (mm)				
	A	B	C	D	d
5572	24,5	3,5	19	6,5	5,3

5572 (White color)

Insulating Protections with Cable Clamp for lampholders

Approved for Class II fittings for flat cable H03VVH2-F 2 x 0.75mm²

Material: Nylon 66

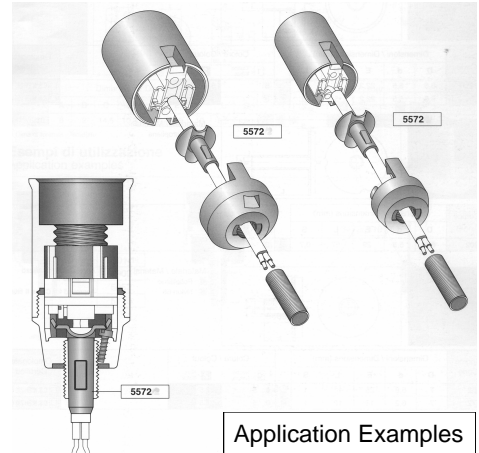

Application Examples

1/8 IPS = Steel Pipe 3/4" OD.
(Slips 7/16" hole)
1/4 IPS = Steel Pipe 1 1/2" OD.
(Slips 9/16" hole)

Lamp Accessories

Multiply Kgs by 2.2046 = pounds
Multiply pounds by 0.4540 = Kgs

Measurements shown in millimeters (mm). To get inches divide mm by 25.4

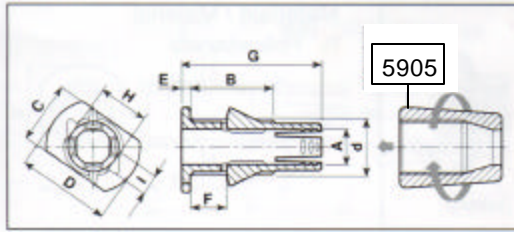

Part Number	Dimensions (mm)									
	A	B	C	D	d	E	F	G	H	I
5580/05	6,5	15	11	16,5	M10x1	1,5	6,5	24,5	8,5	3,5

5580/05

Cord Grip (Cable Clamp) for Round Cables H03VV-F and also Flat Cable H03VVH2-F with adapter 5576
Must be used with 5905 Cap shown below. M10 Thread (1/8 IPS)
Max. load: 7 Kgs (for cable 2x0.75) and 10 Kg (for cable 3x0.75)
Colors: White, Black, Clear Transparent

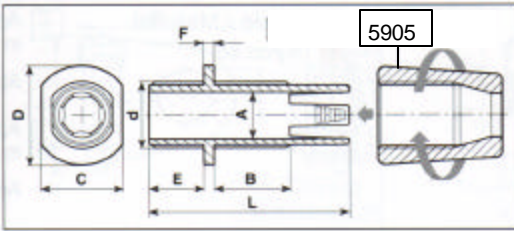

Part Number	Dimensions (mm)								
	A	B	C	D	d	E	F	L	
5915	7	11	12	15	M 10x1	8	1,5	20,5	

Cord Grip (Cable Clamp) for Flat / Round Cables
Must be used with 5905 Cap shown below. M10 Thread (1/8 IPS)
Max. load: 7 Kgs (for cable 2x0.75) 10 Kg (for cable 3x0.75)
Colors: White, Black, Clear Transparent

Approved for Class II fittings

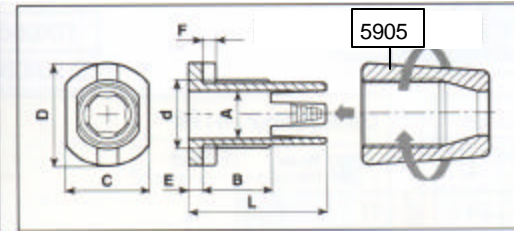

Part Number	Dimensions (mm)								
	A	B	C	D	d	E	F	H	L
5916	7	14,5	12	15	M 10x1	2	2	8,5	24,5
5919	7	19,5	12	15	M 10x1	2	2	8,5	29,5

Cord Grip (Cable Clamp) for Flat / Round Cables
Must be used with 5905 Cap shown below. M10 Thread (1/8 IPS)
Max. load: 7 Kgs (for cable 2x0.75) 10 Kg (for cable 3x0.75)
Colors for 5916: White, Black, Gold, Clear Transparent
Colors for 5919: Clear Transparent

Approved for Class II fittings

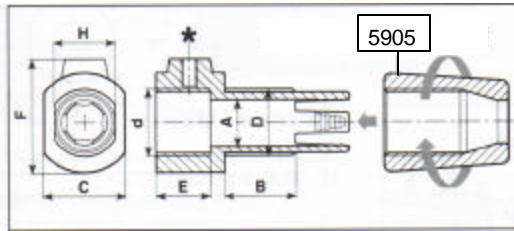

Part Number	Dimensions (mm)							
	A	B	C	D	d	E	F	H
5917	7	10,5	12	M 10x1	M 10x1	8	17	-

Cord Grip (Cable Clamp) for Flat / Round Cables
Must be used with 5905 Cap shown below. M10 Thread (1/8 IPS)
Max. load: 7 Kgs (for cable 2x0.75) 10 Kg (for cable 3x0.75)
Colors: White, Black, Clear Transparent

Approved for Class II fittings

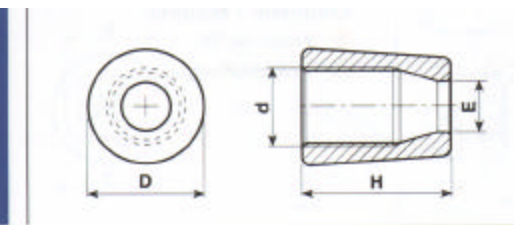

Part Number	Dimensions (mm)			
	D	d	E	H
5905	14,8	M 10x1	7,1	18,5

Cap for Cord Grips 5580/05, 5915, 5916, 5917 and 5919 shown above.

Colors: White, Black, Gold, Clear Transparent and also available in Solid Raw Brass.

1/8 IPS = Steel Pipe 3/4" OD.
(Slips 7/16" hole)
1/4 IPS = Steel Pipe 1/2" OD.
(Slips 9/16" hole)

Lamp Accessories - Clear Transparent

Measurements shown in millimeters (mm). To get inches divide mm by 25.4

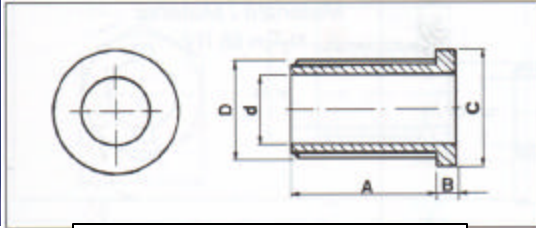

See Page 76 for Bushing (Grommet)

Part Number	Dimensions (mm)				
	A	B	C	D	d
5016/3/7/C	7	2	12	M 10x1	7

Bushing Nipples M10x1 (1/8 IPS) threaded outside only; inside is smooth; Clear Transparent
Max. tightening torque = 130 N cm;
For all nipples thread has ± 1mm tolerance.

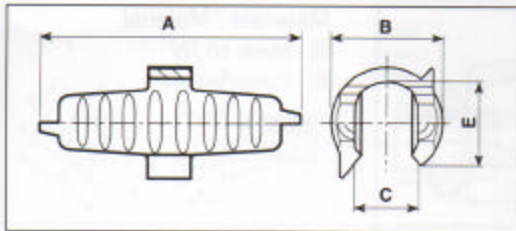

Part Number	Dimensions (mm)			
	A	B	C	E
5576	15,8	6,8	3,3	5,5

Cable clamp Adapter for Cord Grips 5915, 5916, 5917 and 5919. Adapts these cord grips to fit Flat Cable instead of Round.
See application examples shown below.

Application Examples

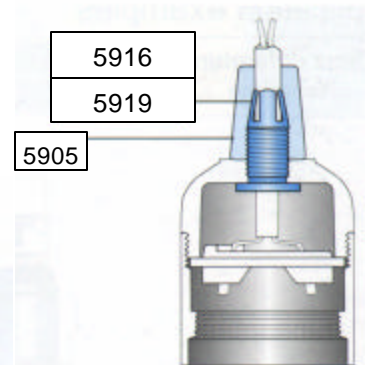
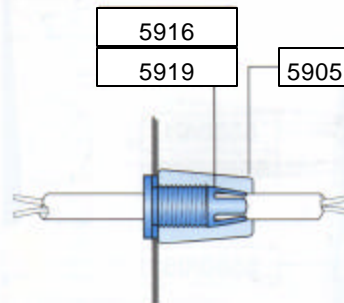
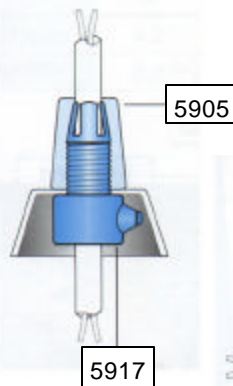
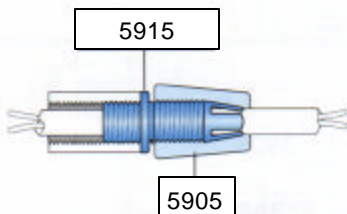
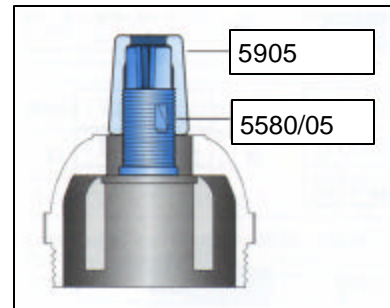
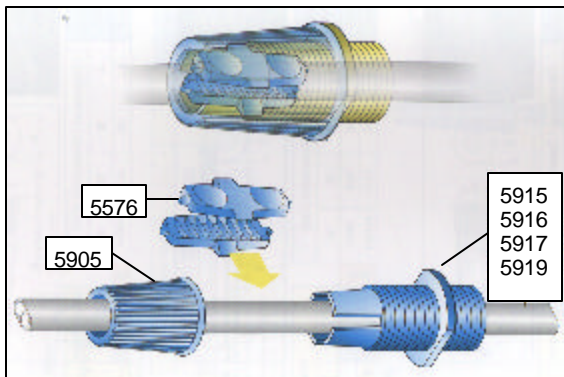

Lamp Accessories

1/8 IPS = Steel Pipe 3/4" OD.
(Slips 7/16" hole)
1/4 IPS = Steel Pipe 1/2" OD.
(Slips 9/16" hole)

Measurements shown in millimeters (mm). To get inches divide mm by 25.4

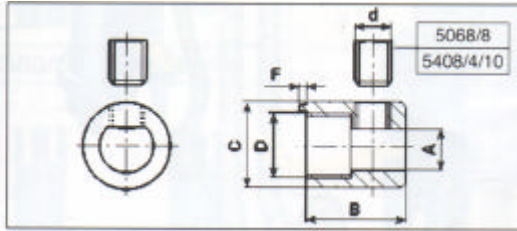

Part Number	Dimensions (mm)					
	A	B	C	D	d	F
5069	6	16,5	14,5	M10x1	M7x1	1

5069

Cord Grip (Cable Clamp) for Flat / Round Cables
M10 Thread (1/8 IPS)

Colors: White, Black, Clear Transparent

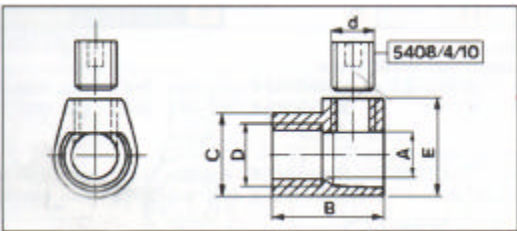

Part Number	Dimensions (mm)					
	A	B	C	D	d	E
5069/7	7	18	13,5	M10x1	M7x1	16

5069/7

Cord Grip (Cable Clamp) for Flat Cable (H03VVH2-F)
and for Round Cable (2 or 3 core H03VV-F)
M10 Thread (1/8 IPS)

Colors: White, Black, Clear Transparent

Application Examples

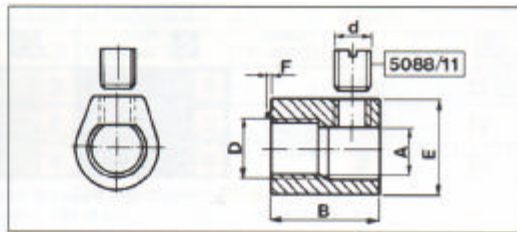
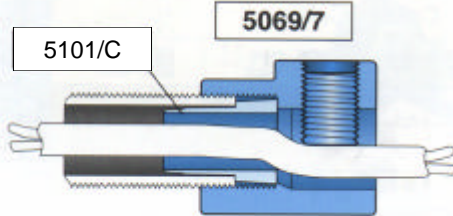

Part Number	Dimensions (mm)					
	A	B	D	d	E	F
5127	10	23	M 13x1	M8x1,25	20	1

5127

Cord Grip (Cable Clamp) supplied with threaded grub
Material: Nylon 66 RV; Approved for Class I fittings
For Round Cable H03VV-F min Ø 8 mm
Suitable for 1/4 IPS Pipe (1/2" O.D.) and SJT-3 Wire.
Colors: White, Black

Application Example

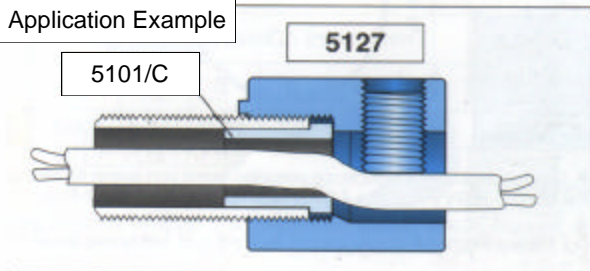

5127 Cord Grip (Cable Clamp)
is suitable for SJT Wire and also
fits 1/4 IPS (1/2" O.D. steel pipe).

Lamp Accessories - Plastic

Measurements shown in millimeters (mm). To get inches divide mm by 25.4

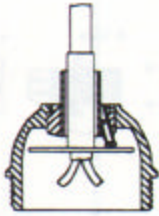

307

Wire Insulators for Candelabra Base Caps
For E12, E14 and B15 lamp bases

302

Wire Insulators for Medium Base Caps
For E26, E27 and B22 lamp bases

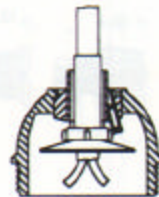
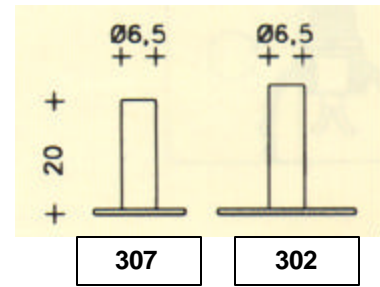

364

Cord Grip Insulators for Candelabra Base Caps
For E12, E14 and B15 lamp bases
For Flat Cable H03VVH2-F (HP07)

365

Cord Grip Insulators for Medium Base Caps
For E26, E27 and B22 lamp bases
For Flat Cable H03VVH2-F (HP07)

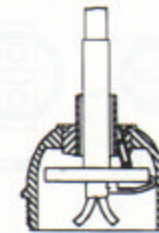
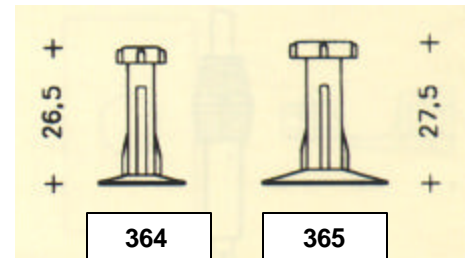

374

Cord Grip Insulators for Candelabra Base Caps
For E12, E14 and B15 lamp bases
For Flat Cable H03VVH2-F (HP07)

377

Cord Grip Insulators for Medium Base Caps
For E26, E27 and B22 lamp bases
For Flat Cable H03VVH2-F (HP07)

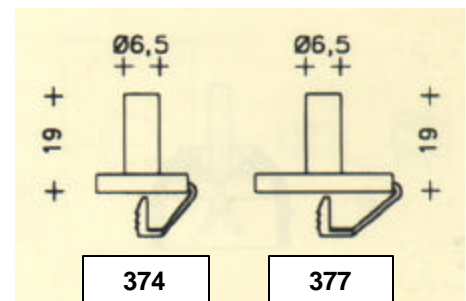

326

Hex Bushing - Plastic Nipple M10 x 1
(for 1/8 IPS) length 9 mm

326/L

Hex Bushing - Plastic Nipple M10 x 1
(for 1/8 IPS) length 15 mm

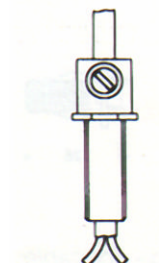
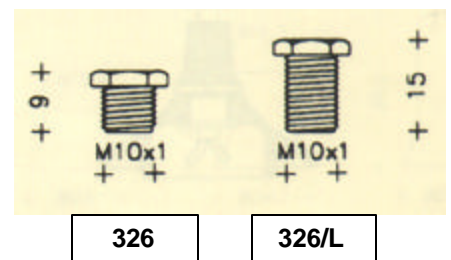

387

Cord Grip with Grub Screw
M10 x 1 (1/8 IPS) for metal all threads
For Flat cable H03VVH2-F (HP07) and
For Round cable H03VV-F (H207, H307)

